

NOTICE!!

These documents have been scanned!

Do not place un-scanned documents beneath this notice!

Do not remove this notice from this file!

GPO Jacket No. 560-102
Print Order 61540
Rise Business Services, LLC
Job=AZ15 4/26/2019



Box Number= AZ15003



Claim Begin-End: AMC449117-AMC449122

1 Initial Receipt



AZ15003-41

AMC450400-AMC453366

United States Department of the Interior
Bureau of Land Management
 DIV OF LANDS, MINRLS & ENERGY
 ONE N CENTRAL AVE
 PHOENIX, AZ 85004 -4427
 Phone: 602-417-9200

Receipt

No: 4092763

Transaction #: 4205007
Date of Transaction: 02/21/2018

CUSTOMER:

RANDY SEALEY
 1127 VICTORY AVE
 BILLINGS, MT 59105-1856 US

ENTERED
 FEB 22 2018
 BY: *R. Han*

LINE #	QTY	DESCRIPTION	REMARKS	UNIT PRICE	TOTAL
1	6.00	LOCATABLE MINERALS / MINING CLAIMS-NEW, UNADJUD, ONE OR MORE AUTH NOS / NEW MINING CLAIM PROCESSING FEE CASES: AMC449117/\$20.00, AMC449118/\$20.00, AMC449119/\$20.00, AMC449120/\$20.00, AMC449121/\$20.00, AMC449122/\$20.00		- n/a -	120.00
2	6.00	LOCATABLE MINERALS / MINING CLAIMS-NEW, UNADJUD, ONE OR MORE AUTH NOS / NEW MINING CLAIMS LOCATION FEE CASES: AMC449117/\$37.00, AMC449118/\$37.00, AMC449119/\$37.00, AMC449120/\$37.00, AMC449121/\$37.00, AMC449122/\$37.00		- n/a -	222.00
3	6.00	LOCATABLE MINERALS / MINING CLAIMS-NEW, UNADJUD, ONE OR MORE AUTH NOS / NEW MINING CLAIMS MAINTENANCE FEE CASES: AMC449117/\$155.00, AMC449118/\$155.00, AMC449119/\$155.00, AMC449120/\$155.00, AMC449121/\$155.00, AMC449122/\$155.00		- n/a -	930.00
4	2.00	LOCATABLE MINERALS / MINING CLAIMS-NOT NEW-UNADJUD, ONE AUTH NO. ONLY / MINING CLAIM MONEY RECEIVED CASES: AMC449117/\$155.00, AMC449120/\$155.00	ADDL MAINT FEE FOR ASSOC PLACER	- n/a -	310.00

TOTAL:	\$1,582.00
---------------	-------------------

PAYMENT INFORMATION			
1	AMOUNT:	1582.00	POSTMARKED: N/A
	TYPE:	CHECK	RECEIVED: 02/21/2018
	CHECK NO:	3077	
	NAME:	GOLDROCK MINERALS LLC 1127 VICTORY AVE BILLINGS MT 59105-1856 US	

REMARKS

This receipt was generated by the automated BLM Collections and Billing System and is a paper representation of a portion of the official electronic record contained therein.

NOTICE!!

These documents have been scanned!

Do not place un-scanned documents beneath this notice!

Do not remove this notice from this file!

GPO Jacket No. 560-102
Print Order 61540
Rise Business Services, LLC
Job=AZ15 4/26/2019



Box Number= AZ15003



Claim Begin-End: AMC449117-AMC449122

2 Correspondence



AZ15003-41

AMC450400-AMC453366



United States Department of the Interior

BUREAU OF LAND MANAGEMENT

Arizona State Office

One North Central Avenue, Suite 800

Phoenix, Arizona 85004-4427

www.blm.gov/az/



DEC 18 2018

In Reply Refer To:

3830 (9200) PB

AMC449117

CERTIFIED MAIL - RETURN RECEIPT REQUESTED No. 9214 8901 9403 8376 3499 65

DECISION

TRISH EDWARDS and RANDY L SEALEY :
1127 VICTORY AVE :
BILLINGS, MT 59105-1856 :

This decision affects those claims
shown in the block below.

AMC449117
ROGERS 26-1

MINING CLAIMS DECLARED FORFEITED

The mining claims listed above have been declared forfeited as of September 1, 2018, for failure to timely file the required maintenance fee payment or small miner's maintenance fee waiver (waiver).

Claimants are required to pay an annual non-refundable maintenance fee of \$155 per 20 acres or portion thereof, or submit a waiver, on or before September 1 of each year. These requirements were established by 30 U.S.C. 28f-1, as amended, and 43 CFR 3834 and 3835.

Our records do not show receipt of a maintenance fee payment or small miner waiver filed on or before the due date. Therefore, the claims listed above are forfeited.

Reclamation Requirements

This decision does not relieve you of the liability for reclamation of all areas disturbed by your activities on lands covered by the subject mining claim(s) and/or site(s). After you complete the reclamation, you must notify the authorized officer of the appropriate surface managing agency so that the authorized officer may conduct a final site inspection and determine whether you may

be released from liability. If you fail to reclaim the land to the satisfaction of the authorized officer, the surface management agency may cite you for noncompliance under its surface management regulations. For land administered by the Bureau of Land Management (BLM), if you fail to reclaim the land to the satisfaction of the authorized officer as required in 43 CFR Subpart 3809, the BLM will issue an order of noncompliance under 43 CFR 3809.601(a). If you fail to comply with the non-compliance order, BLM may take further action under 43 CFR 3809.604. Failure to conduct reclamation is a prohibited act that may subject you to criminal penalties. See 43 CFR 3809.605(h) and 43 CFR 3809.700.

Appeal Procedures

This decision may be appealed to the Interior Board of Land Appeals, Office of the Secretary, in accordance with the regulations contained in 43 CFR, Part 4, and the enclosed Form 1842-1. If an appeal is taken, your notice of appeal must be filed in this office (at the above address) within 30 days from receipt of this decision. The appellant has the burden of showing that the decision appealed from is in error.

If you wish to file a petition pursuant to regulation 43 CFR 4.21 (58 FR 4939, January 19, 1993) for a stay of the effectiveness of this decision during the time that your appeal is being reviewed by the Board, the petition for a stay must accompany your notice of appeal. A petition for a stay is required to show sufficient justification based on the standards listed below. Copies of the notice of appeal and petition for a stay **must** also be submitted to each party named in this decision and to the Interior Board of Land Appeals and to the appropriate Office of the Solicitor (see 43 CFR 4.413) at the same time the original documents are filed with this office. If you request a stay, you have the burden of proof to demonstrate that a stay should be granted.

Standards for Obtaining a Stay

Except as otherwise provided by law or other pertinent regulation, a petition for a stay of a decision pending appeal shall show sufficient justification based on the following standards:

- (1) The relative harm to the parties if the stay is granted or denied,
- (2) The likelihood of the appellant's success on the merits,
- (3) The likelihood of immediate and irreparable harm if the stay is not granted, and
- (4) Whether the public interest favors granting the stay.

Please include your AMC serial number(s) on all correspondence. If additional information is required, please call Pauline Brown at 602-417-9360.

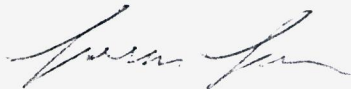

Lucas Lucero
Deputy State Director
Lands, Minerals, and Energy Division

Enclosure



Date Produced: 12/31/2018

ConnectSuite Inc.:

The following is the delivery information for Certified Mail™/RRE item number 9214 8901 9403 8376 3499 65. Our records indicate that this item was delivered on 12/24/2018 at 04:49 p.m. in BILLINGS, MT 59105. The scanned image of the recipient information is provided below.

Signature of Recipient :

A handwritten signature in black ink, appearing to read "Trish Edwards".

Trish Edwards

Address of Recipient :

1127 Victory Ave

Thank you for selecting the Postal Service for your mailing needs. If you require additional assistance, please contact your local post office or Postal Service representative.

Sincerely,
United States Postal Service

The customer reference number shown below is not validated or endorsed by the United States Postal Service. It is solely for customer use.

Customer Reference Number: C1128145.6489307

NOTICE!!

These documents have been scanned!

Do not place un-scanned documents beneath this notice!

Do not remove this notice from this file!

GPO Jacket No. 560-102
Print Order 61540
Rise Business Services, LLC
Job=AZ15 4/26/2019



Box Number= AZ15003



Claim Begin-End: AMC449117-AMC449122

3 Transfers



AZ15003-41

AMC450400-AMC453366

**NO
DOCUMENTS
FOUND**

NO DOCUMENTS FOUND
NO DOCUMENTS FOUND

NOTICE!!

These documents have been scanned!

Do not place un-scanned documents beneath this notice!

Do not remove this notice from this file!

GPO Jacket No. 560-102
Print Order 61540
Rise Business Services, LLC
Job=AZ15 4/26/2019



Box Number= AZ15003



Claim Begin-End: AMC449117-AMC449122

4 Annual Filings



AZ15003-41

AMC450400-AMC453366

DEPARTMENT OF THE INTERIOR
BUREAU OF LAND MANAGEMENT
MINING CLAIMS

Run Date/Time: 9/11/2018

MC Maintenance Fees Paid Through the BLM Pay Portal
(by Date Paid)

Page 513 Of 723

CBS Receipt: 4250947

Printed For Lead File # **AMC449117**

Agency Tracking ID: 1535643135

Assessment Year: 2019

Paid On: 8/30/2018

Number of BLM Serial Nr: 17

Total Amount Paid: \$3,410.00

Claim Name	BLM Serial No	Lead File No	Amount Paid
WESTERN SUN 1	AMC396407	AMC396401	\$155.00
WESTERN SUN 2	AMC396408	AMC396401	\$155.00
WESTERN SUN 3	AMC396409	AMC396401	\$155.00
ROGERS 27-1	AMC449112	AMC449112	\$155.00
ROGERS 27-2	AMC449113	AMC449112	\$155.00
ROGERS 27-3	AMC449114	AMC449112	\$155.00
ROGERS 27-4	AMC449115	AMC449112	\$155.00
ROGERS 27-5	AMC449118	AMC449117	\$155.00
ROGERS 27-6	AMC449119	AMC449117	\$155.00
ROGERS 33-1	AMC449120	AMC449117	\$310.00
ROGERS 34-1	AMC449121	AMC449117	\$155.00
ROGERS 34-2	AMC449122	AMC449117	\$155.00
SAN #35-0	AMC450034	AMC450029	\$310.00
SAN #35-1	AMC450035	AMC450029	\$310.00
SAN #35-2	AMC450036	AMC450029	\$310.00
SAN 35-3	AMC450037	AMC450029	\$310.00
SAN 35-4	AMC450038	AMC450029	\$155.00

United States Department of the Interior

Bureau of Land Management

BUSINESS & SUPPORT SVCS DIV

ONE N CENTRAL AVE SUITE 800

PHOENIX, AZ 85004 -4427

Phone: 602-417-9200

Receipt

No: 4250947

Transaction #: 4366455	
Date of Transaction: 08/30/2018	
CUSTOMER:	
	RANDY SEALEY 1127 VICTORY AVE BILLINGS,MT 59105 US

LINE #	QTY	DESCRIPTION	REMARKS	UNIT PRICE	TOTAL
1	1.00	LOCATABLE MINERALS / MINING CLAIMS- NOT NEW-UNADJUD,ONE AUTH NO. ONLY / MINING CLAIM MONEY RECEIVED CASES: AMC396407/\$3410.00		- n/a -	3410.00
TOTAL:					\$3,410.00

PAYMENT INFORMATION				
NOTE: Items will appear on credit card statement as "BLM O Mining Claim".				
1	AMOUNT:	3410.00	POSTMARKED:	N/A
	TYPE:	CREDIT CARD	RECEIVED:	08/30/2018
	NAME:	RANDY SEALEY 1127 VICTORY AVE BILLINGS MT 59105 US		
	CARD NO:	XXXXXXXXXXXX5200	AUTH CODE:	08646A
	NAME ON CARD:	RANDY SEALEY		
	SIGNATURE:			

REMARKS

This receipt was generated by the automated BLM Collections and Billing System and is a paper representation of a portion of the official electronic record contained therein.

NOTICE!!

These documents have been scanned!

Do not place un-scanned documents beneath this notice!

Do not remove this notice from this file!

GPO Jacket No. 560-102
Print Order 61540
Rise Business Services, LLC
Job=AZ15 4/26/2019



Box Number= AZ15003



Claim Begin-End: AMC449117-AMC449122

5 Miscellaneous

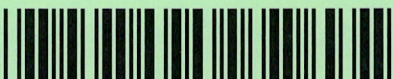

AZ15003-41

AMC450400-AMC453366

**DEPARTMENT OF THE INTERIOR
BUREAU OF LAND MANAGEMENT
MINING CLAIMS**

Run Date/Time: 03/26/2018 10:17 AM

(LIVE) Serial Register Page

Page 1 of 6

01 10-21-1976;090STAT0090;43USC1744

Case Type 384201: PLACER CLAIM

Claim Name: ROGERS 26-1

Commodity :

Case Disposition: ACTIVE

Required Maintenance Fee: \$310.00

Total Acres

40.000

Serial Number

AMC449117

Lead File Number

AMC449117

Name & Address

Int Rel

EDWARDS TRISH	1127 VICTORY AVE	BILLINGS, MT 59105-1856	CLAIMANT
SEALEY RANDY L	1127 VICTORY AVE	BILLINGS, MT 59105-1856	CLAIMANT

Mer Twp	Rng	Sec	Quadrant	District/Field Office	County
14	0070N	0040W	026	SW	HASSAYAMPA FO
					MARICOPA

Act Date	Code	Action	Action Remarks	Receipt Number
----------	------	--------	----------------	----------------

02/20/2018	403	LOCATION DATE		
02/21/2018	395	RECORDATION NOTICE RECD	1	4092763
02/21/2018	484	LOCATION YEAR / MAINTENANCE 2018;\$155		4092763
03/23/2018	669	LAND STATUS CHECKED		
02/21/2018	404	COUNTY RECORDATION	2018-0129045;	
02/21/2018	501	ACCT ADV IN LEAD FILE	AMC449117-AMC449122;	
02/21/2018	685	ADDL MAINTENANCE FEE	2018;\$155	4092763

Line Nr Remarks

**NO WARRANTY IS MADE BY BLM
FOR USE OF THE DATA FOR
PURPOSES NOT INTENDED BY BLM**

DEPARTMENT OF THE INTERIOR
BUREAU OF LAND MANAGEMENT
MINING CLAIMS

Run Date/Time: 03/26/2018 10:17 AM

(LIVE) Serial Register Page

Page 2 of 6

01 10-21-1976;090STAT0090;43USC1744

Total Acres

Serial Number

Case Type 384201: PLACER CLAIM

20.000

AMC449118

Claim Name: ROGERS 27-5

Lead File Number

Commodity :

AMC449117

Case Disposition: ACTIVE

Required Maintenance Fee: \$155.00

Name & Address

Int Rel

SEALEY RANDY L

1127 VICTORY AVE

BILLINGS, MT 59105-1856

CLAIMANT

Mer Twp Rng Sec Quadrant

District/Field Office

County

14 0070N 0040W 027

SE

HASSAYAMPA FO

MARICOPA

Act Date	Code	Action	Action Remarks	Receipt Number
02/16/2018	403	LOCATION DATE		
02/21/2018	395	RECORDATION NOTICE RECD	1	4092763
02/21/2018	484	LOCATION YEAR / MAINTENANCE 2018;\$155		4092763
03/23/2018	669	LAND STATUS CHECKED		
02/21/2018	404	COUNTY RECORDATION	2018-0129050;	
02/21/2018	501	ACCT ADV IN LEAD FILE	AMC449117-AMC449122;	

Line Nr Remarks

**DEPARTMENT OF THE INTERIOR
BUREAU OF LAND MANAGEMENT
MINING CLAIMS**

Run Date/Time: 03/26/2018 10:17 AM

(LIVE) Serial Register Page

Page 3 of 6

01 10-21-1976;090STAT0090;43USC1744

Case Type 384201: PLACER CLAIM

Claim Name: ROGERS 27-6

Commodity :

Case Disposition: ACTIVE

Required Maintenance Fee: \$155.00

Total Acres

20.000

Serial Number

AMC449119

Lead File Number

AMC449117

Name & Address

Int Rel

SEALEY RANDY L

1127 VICTORY AVE

BILLINGS, MT 59105-1856

CLAIMANT

Mer Twp Rng Sec Quadrant

District/Field Office

County

14 0070N 0040W 027

SW

HASSAYAMPA FO

MARICOPA

Act Date

Code Action

Action Remarks

Receipt Number

02/16/2018

403

LOCATION DATE

02/21/2018

395

RECORDATION NOTICE RECD 1

4092763

02/21/2018

484

LOCATION YEAR / MAINTENANCE 2018;\$155

4092763

03/23/2018

669

LAND STATUS CHECKED

02/21/2018

404

COUNTY RECORDATION 2018-0129049;

02/21/2018

501

ACCT ADV IN LEAD FILE AMC449117-AMC449122;

Line Nr Remarks

NO WARRANTY IS MADE BY BLM
FOR USE OF THE DATA FOR
PURPOSES NOT INTENDED BY BLM

DEPARTMENT OF THE INTERIOR
BUREAU OF LAND MANAGEMENT
MINING CLAIMS

Run Date/Time: 03/26/2018 10:18 AM

(LIVE) Serial Register Page

Page 4 of 6

01 10-21-1976;090STAT0090;43USC1744

Case Type 384201: PLACER CLAIM

Claim Name: ROGERS 33-1

Commodity :

Case Disposition: ACTIVE

Required Maintenance Fee: \$310.00

Total Acres
40.000

Serial Number
AMC449120
Lead File Number
AMC449117

Name & Address

Int Rel

EDWARDS TRISH	1127 VICTORY AVE	BILLINGS, MT 59105-1856	CLAIMANT
SEALEY RANDY L	1127 VICTORY AVE	BILLINGS, MT 59105-1856	CLAIMANT

Mer Twp	Rng	Sec	Quadrant	District/Field Office	County	
14	0070N	0040W	033	NE	HASSAYAMPA FO	MARICOPA

Act Date	Code	Action	Action Remarks	Receipt Number
02/19/2018	403	LOCATION DATE		
02/21/2018	395	RECORDATION NOTICE RECD	1	4092763
02/21/2018	484	LOCATION YEAR / MAINTENANCE	2018;\$155	4092763
03/23/2018	669	LAND STATUS CHECKED		
02/21/2018	404	COUNTY RECORDATION	2018-0129048;	
02/21/2018	501	ACCT ADV IN LEAD FILE	AMC449117-AMC449122;	
02/21/2018	685	ADDL MAINTENANCE FEE	2018;\$155	4092763

Line Nr Remarks

**DEPARTMENT OF THE INTERIOR
BUREAU OF LAND MANAGEMENT**

MINING CLAIMS

(LIVE) Serial Register Page

Run Date/Time: 03/26/2018 10:18 AM

Page 5 of 6

01 10-21-1976;090STAT0090;43USC1744

Case Type 384201: PLACER CLAIM

Claim Name: ROGERS 34-1

Commodity :

Case Disposition: ACTIVE

Required Maintenance Fee: \$155.00

Total Acres

20.000

Serial Number

AMC449121

Lead File Number

AMC449117

Name & Address

Int Rel

SEALEY RANDY L

1127 VICTORY AVE

BILLINGS, MT 59105-1856

CLAIMANT

Mer Twp Rng Sec Quadrant

District/Field Office

County

14 0070N 0040W 034

NW

HASSAYAMPA FO

MARICOPA

Act Date

Code Action

Action Remarks

Receipt Number

02/18/2018

403

LOCATION DATE

02/21/2018

395

RECORDATION NOTICE RECD

1

4092763

02/21/2018

484

LOCATION YEAR / MAINTENANCE 2018;\$155

4092763

03/23/2018

669

LAND STATUS CHECKED

02/21/2018

404

COUNTY RECORDATION

2018-0129047;

02/21/2018

501

ACCT ADV IN LEAD FILE

AMC449117-AMC449122;

Line Nr Remarks

DEPARTMENT OF THE INTERIOR
BUREAU OF LAND MANAGEMENT...
MINING CLAIMS

Run Date/Time: 03/26/2018 10:18 AM

(LIVE) Serial Register Page

Page 6 of 6

01 10-21-1976;090STAT0090;43USC1744

Total Acres

Serial Number

Case Type 384201: PLACER CLAIM

10.000

AMC449122

Claim Name: ROGERS 34-2

Lead File Number

Commodity :

AMC449117

Case Disposition: ACTIVE

Required Maintenance Fee: \$155.00

Name & Address

Int Rel

SEALEY RANDY L

1127 VICTORY AVE

BILLINGS, MT 59105-1856

CLAIMANT

Mer Twp Rng Sec Quadrant

District/Field Office

County

14 0070N 0040W 034

NW

HASSAYAMPA FO

MARICOPA

Act Date	Code	Action	Action Remarks	Receipt Number
02/18/2018	403	LOCATION DATE		
02/21/2018	395	RECORDATION NOTICE RECD	1	4092763
02/21/2018	484	LOCATION YEAR / MAINTENANCE 2018;\$155		4092763
03/23/2018	669	LAND STATUS CHECKED		
02/21/2018	404	COUNTY RECORDATION	2018-0129046;	
02/21/2018	501	ACCT ADV IN LEAD FILE	AMC449117-AMC449122;	

Line Nr Remarks

NOTICE!!

These documents have been scanned!

Do not place un-scanned documents beneath this notice!

Do not remove this notice from this file!

GPO Jacket No. 560-102
Print Order 61540
Rise Business Services, LLC
Job=AZ15 4/26/2019



Box Number= AZ15003



Claim Begin-End: AMC449117-AMC449122

6 Location Notices-Amendments and Supporting Documents



AZ15003-41

AMC450400-AMC453366

MINING CLAIM STATUS REPORT

Data Entered: 2/22/18 Rm

MTP Checked By: 2/22/18 Rm
GEO Checked By: 2/22/18 Rm

LEAD SERIAL NUMBER: AMC 449117 thru AMC 449122

NUMBER OF CLAIMS & TYPE:

4 LODE
2 PLACER
2 ASSOCIATION PLACER
MILL SITE
TUNNEL SITE

TOTAL ACREAGE: 20 + 40 (Assoc) Per Claim
(Placer Only)

NUMBER OF LOCATORS: 1 or 2 for (Assoc.)

CHARGES:

Processing Fee @ \$20 = \$ 120
Location Fee @ \$37 = \$ 222
Maintenance Fee @ \$155 = \$ 930
Add'l Maint Fee for Assoc Placer = \$ 310
SUBTOTAL \$ 1582
Other Fees \$
Other Fees \$
TOTAL \$

DOCUMENTS RECEIVED VIA: Over-the-Counter ☒ Mail ☐ TIMELY FILED: Yes ☒ No ☐

LEGAL DESCRIPTION: T 7N R 4W SEC 26 27 33 34
T R SEC
T R SEC
T R SEC
T R SEC

BLM ☐ FOREST SERVICE ☐ SUBJ TO PL 359: Yes ☐ No ☐
WILDERNESS AREA ☐

SPLIT ESTATE: N/A ☐ SX ☐ PX ☐ OTHER ☐
SRHA ☐ Was proper Notice filed if located on SHRA Land? Yes ☐ No ☐

RECONVEYED MINERALS ON BLM LAND REQUIRE OPENING ORDER FROM 1944 TO 1993:

Open to Entry On N/A ☐

COMMENTS/STATUS: VOID ☐ PARTIALLY VOID ☐ PVT MINERALS ☐ WITHDRAWN LANDS ☐
OTHER ☐

☐ Claimant acknowledges that portions of the following claim(s) site(s) may be void or voidable.

Printed Name of Claimant Signature of Claimant

*****FINAL ADJUDICATION*****

DATE 3/23/18 INITIALS MB

AMC 449117

0169582-2-6-1
castilloe

LOCATION NOTICE FOR PLACER MINING CLAIM

NOTICE IS HEREBY GIVEN that the

The "Rogers #26-1" placer mining claim has been located

by Randy Sealey & Trish Edwards, whose current mailing address is

1127 Victory Ave.,

Billings, Mt. 59105

BLM

Date

Stamp

PHOENIX, ARIZONA

2018 FEB 21 A 11:31

RECEIVED
MARICOPA COUNTY RECORDER
ADRIAN FONTES

The general course of this claim is East and West and it is situated in Maricopa County, Arizona. This claim is 1,320 feet in length and 1,320 feet in width. This claim runs from the location monument on which this location notice is posted approximately 1,320 feet in a W direction to the SW corner and 1,320 feet in a N direction to the NW corner.

Four monuments mark this claim, one at each corner.

The location monument on which this notice is posted is situated within Section 26, Township 7 North, Range 4 West, Gila Salt River Base and Meridian, Arizona and this claim encompasses portions of the following quarter section (s), section (s), Township (s) and Range (s) NE ¼ SW1/4 of Section 26, T7N, R4W Gila Salt River Base and Meridian, Arizona. The locality of this claim with reference to some natural object or permanent monument and additional information (If any) concerning its locality are as follows: This claim is located approximately 2,600' SW of the San Domingo Peak with the wash running E to SW through the claim.

DATED AND POSTED on the ground this 20th day of February, 2018.

LOCATORS: Trish Edwards & Randy Sealey

Signatures

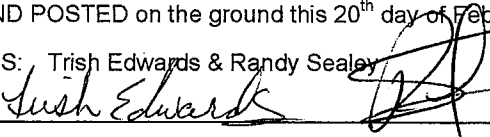

AMC449117

MINING CLAIM MAP

Lode () Placer (X)

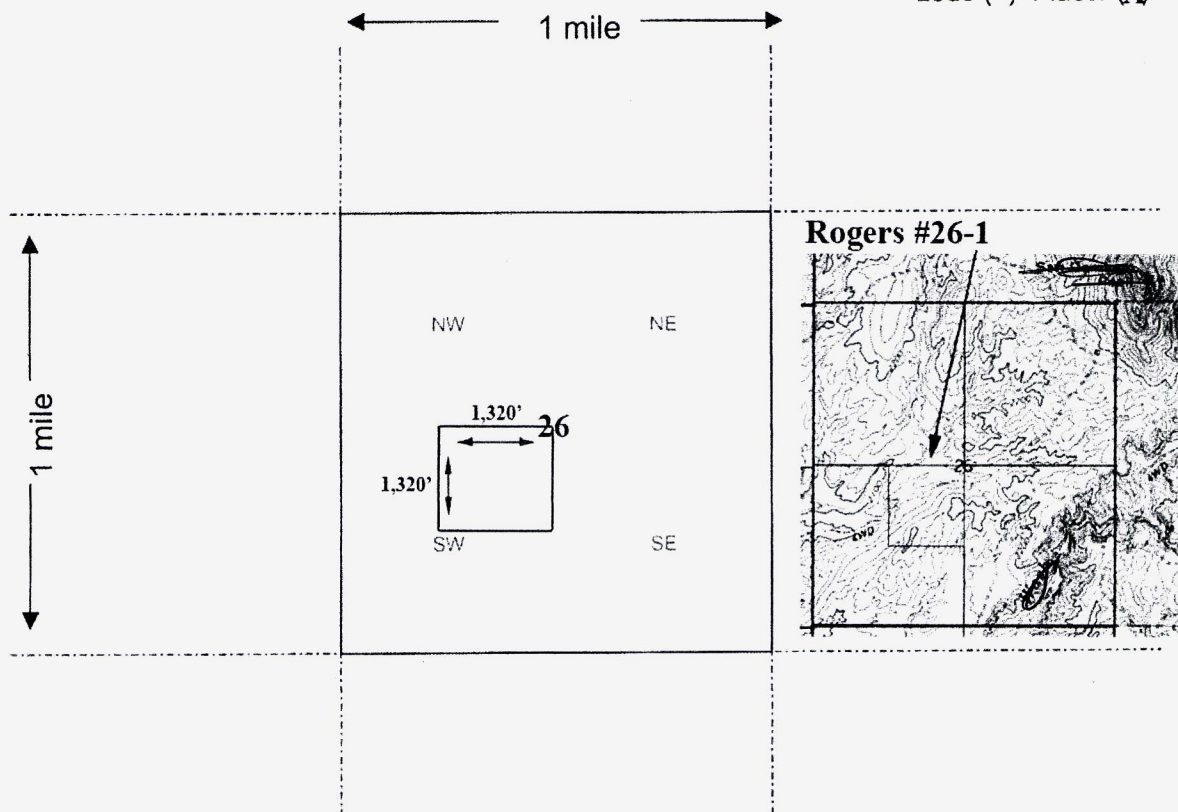

Scale : 1" = 2000 feet



- The above map depicts the Rogers #26-1 mining claim, which is located in Section (s) 26, Township 7 N, Range 4 W, Gila and Salt River Base and Meridian, Maricopa County, Arizona.
- The type of corner and location monuments used are as follows: 1 1/2" Poly Pipe, 4 feet long/ cap
- The bearings and distances in degrees and feet between claim corners are as depicted on the map.

Form MCF100a
Revised July 2005

This form is available from the Arizona Department of Mines & Mineral Resources and may be reproduced.

AMC 449117

2
OFFICIAL RECORDS OF
MARICOPA COUNTY RECORDER
ADRIAN FONTES
2018-0129050 02/21/18 10:32
PAPER RECORDING

0169582-2-6-6
castilloe

LOCATION NOTICE FOR PLACER MINING CLAIM

NOTICE IS HEREBY GIVEN that the

BLM

Date

Stamp

The "Rogers #27-5" placer mining claim has been located

by Randy Sealey, whose current mailing address is

1127 Victory Ave.,

Billings, Mt. 59105

The general course of this claim is East and West and it is situated in Maricopa County, Arizona. This claim is 1,320 feet in length and 660 feet in width. This claim runs from the location monument on which this location notice is posted approximately 1,320' feet in a W direction to the SW corner and 660 feet in a N direction to the NW corner.

Four monuments mark this claim, one at each corner.

The location monument on which this notice is posted is situated within Section 27, Township 7 North, Range 4 West, Gila Salt River Base and Meridian, Arizona and this claim encompasses portions of the following quarter section (s), section (s), Township (s) and Range (s) S1/2 SW1/4 SE1/4 of Section 27, T7N, R4W Gila Salt River Base and Meridian, Arizona. The locality of this claim with reference to some natural object or permanent monument and additional information (If any) concerning its locality are as follows: This claim is located approximately 1.75 miles SW of San Domingo Peak and just south and east of the wash running NE to SW just W and NW of the claim.

DATED AND POSTED on the ground this 16th day of February, 2018.

LOCATOR Randy Sealey

Signature _____

RECEIVED
BLM AZ STATE OFFICE
2018 FEB 21 A 11:31
PHOENIX, ARIZONA

AMC449118

Form MCFIOO
Revised July 2005

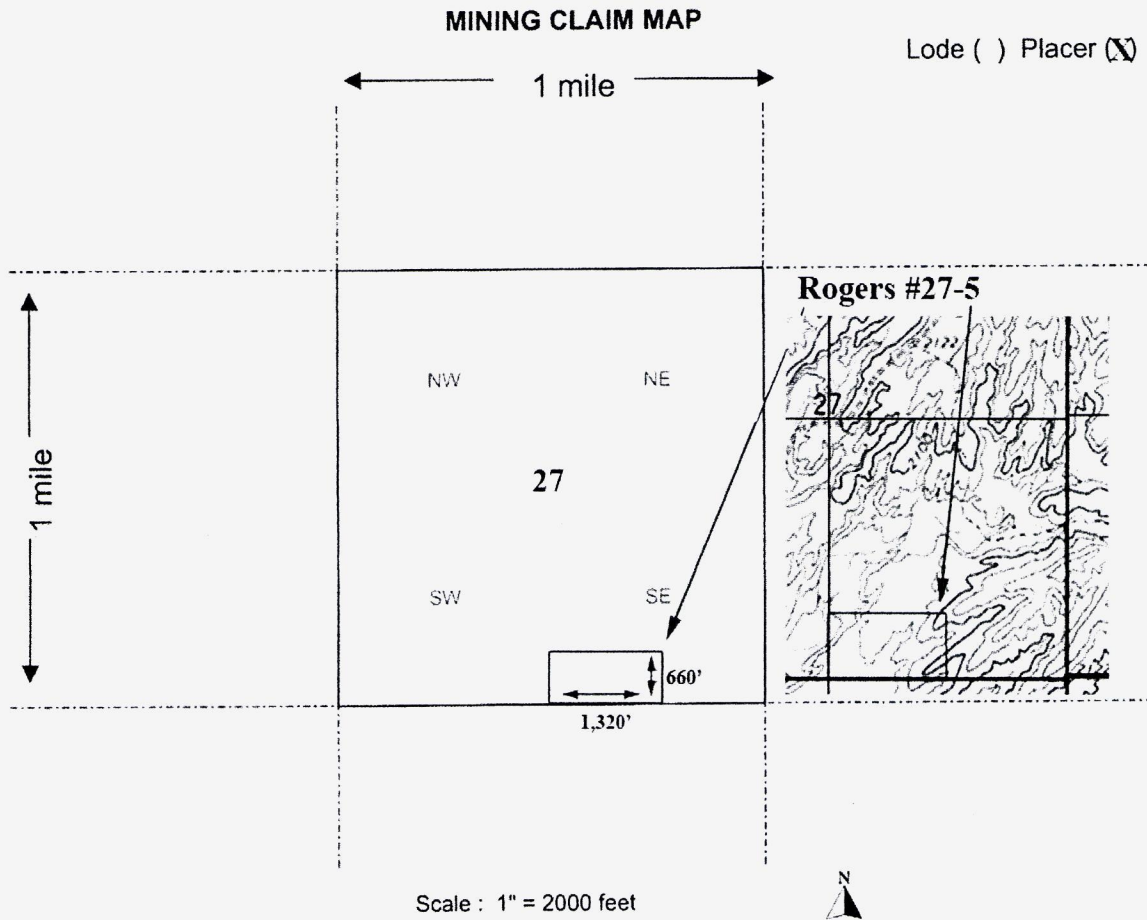

- The above map depicts the **Rogers #27-5** mining claim, which is located in Section (s) **27**, Township **7** **N**, Range **4** **W**, Gila and Salt River Base and Meridian, **Maricopa** County, Arizona.
- The type of corner and location monuments used are as follows: **1 1/2" Poly Pipe, 4 feet long/ cap**
- The bearings and distances in degrees and feet between claim corners are as depicted on the map.

Form MCF100a
Revised July 2005

This form is available from the Arizona Department of Mines & Mineral Resources and may be reproduced.

AHC449118

OFFICIAL RECORDS OF
MARICOPA COUNTY RECORDER
ADRIAN FONTES
2018-0129049 02/21/18 10:32
PAPER RECORDING

0169582-2-6-5
castilloe

LOCATION NOTICE FOR PLACER MINING CLAIM

NOTICE IS HEREBY GIVEN that the

The "Rogers #27-6" placer mining claim has been located

by Randy Sealey, whose current mailing address is

1127 Victory Ave.,

Billings, Mt. 59105

BLM

Date

Stamp

PHOENIX, ARIZONA

2018 FEB 21 A 11:31

RECEIVED
MARICOPA COUNTY
STATE OFFICE

AMC 449119

The general course of this claim is North and South and it is situated in Maricopa County, Arizona. This claim is 1,320 feet in length and 660 feet in width. This claim runs from the location monument on which this location notice is posted approximately 660' feet in a W direction to the SW corner and 1,320 feet in a N direction to the NW corner.

Four monuments mark this claim, one at each corner.

The location monument on which this notice is posted is situated within Section 27, Township 7 North, Range 4 West, Gila Salt River Base and Meridian, Arizona and this claim encompasses portions of the following quarter section (s), section (s), Township (s) and Range (s) E1/2 SE1/4 SW1/4 of Section 27, T7N, R4W Gila Salt River Base and Meridian, Arizona. The locality of this claim with reference to some natural object or permanent monument and additional information (If any) concerning its locality are as follows:

This claim is located approximately 2 miles SW of San Domingo Peak and encompassing the wash running NE to SW through the claim.

DATED AND POSTED on the ground this 16th day of February, 2018.

LOCATOR Randy Sealey

Signature _____

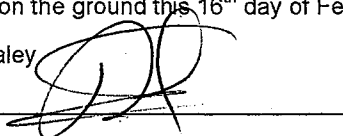

Form MCFIOO
Revised July 2005

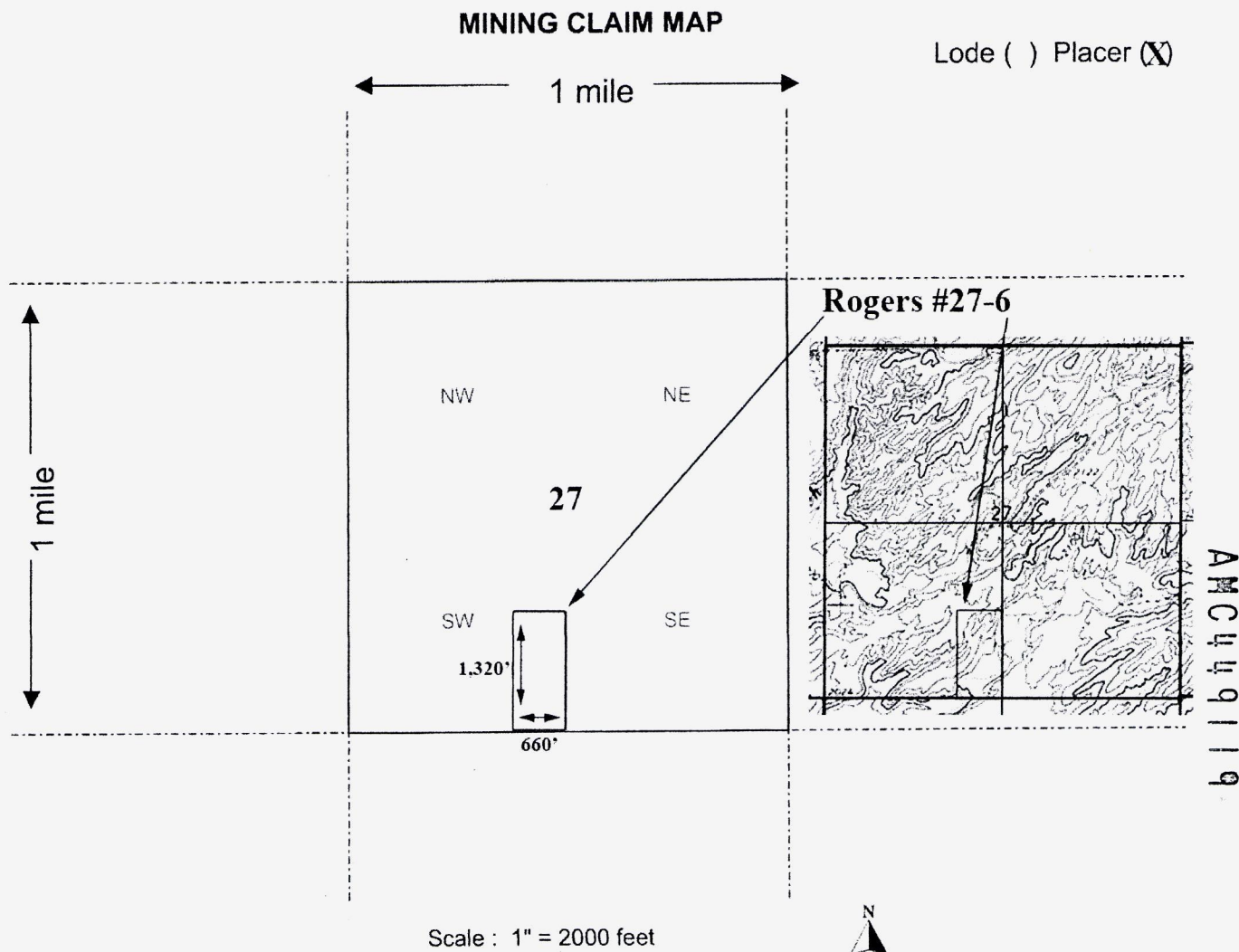

- The above map depicts the **Rogers #27-6** mining claim, which is located in Section (s) **27**, Township **7** **N**, Range **4** **W**, Gila and Salt River Base and Meridian, **Maricopa** County, Arizona.
- The type of corner and location monuments used are as follows: **1 1/2" Poly Pipe, 4 feet long/ cap**
- The bearings and distances in degrees and feet between claim corners are as depicted on the map.

Form MCF100a
Revised July 2005

This form is available from the **Arizona Department of Mines & Mineral Resources** and may be reproduced.

OFFICIAL RECORDS OF
MARICOPA COUNTY RECORDER
ADRIAN FONTES
2018-0129048 02/21/18 10:32
PAPER RECORDING

0169582-2-6-4
castilloe

LOCATION NOTICE FOR PLACER MINING CLAIM

NOTICE IS HEREBY GIVEN that the

The "Rogers #33-1" placer mining claim has been located
by Randy Sealey & Trish Edwards, whose current mailing address is
1127 Victory Ave.,
Billings, Mt. 59105

BLM

Date

Stamp

PHOENIX, ARIZONA

2018 FEB 21 A 11:31

RECEIVED
MARICOPA COUNTY RECORDER

The general course of this claim is East and West and it is situated in Maricopa
County, Arizona. This claim is 1,320 feet in length and 1,320 feet in width. This claim runs
from the location monument on which this location notice is posted approximately 1,320 feet in a
W direction to the SW corner and 1,320 feet in a N direction to the NW corner.
Four monuments mark this claim, one at each corner.

The location monument on which this notice is posted is situated within Section 33, Township 7 North,
Range 4 West, Gila Salt River Base and Meridian, Arizona and this claim encompasses portions
of the following quarter section (s), section (s), Township (s) and Range (s) S1/2 NE1/4 NE1/4 & N1/2 SE1/4 NE1/4 of
Section 33, T7N, R4W Gila Salt River Base and Meridian, Arizona. The locality of this claim with reference to some
natural object or permanent monument and additional information (if any) concerning its locality are as follows:
This claim is located approximately 2,600' SW of the 1/4 mile US Survey Marker located between S 27 & S 34 with the
wash running E to SW through the claim.

DATED AND POSTED on the ground this 19th day of February, 2018.

LOCATORS: Trish Edwards & Randy Sealey

Signatures

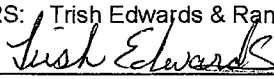
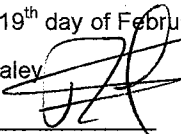
Form MCFIOO
Revised July 2005

AMC449120

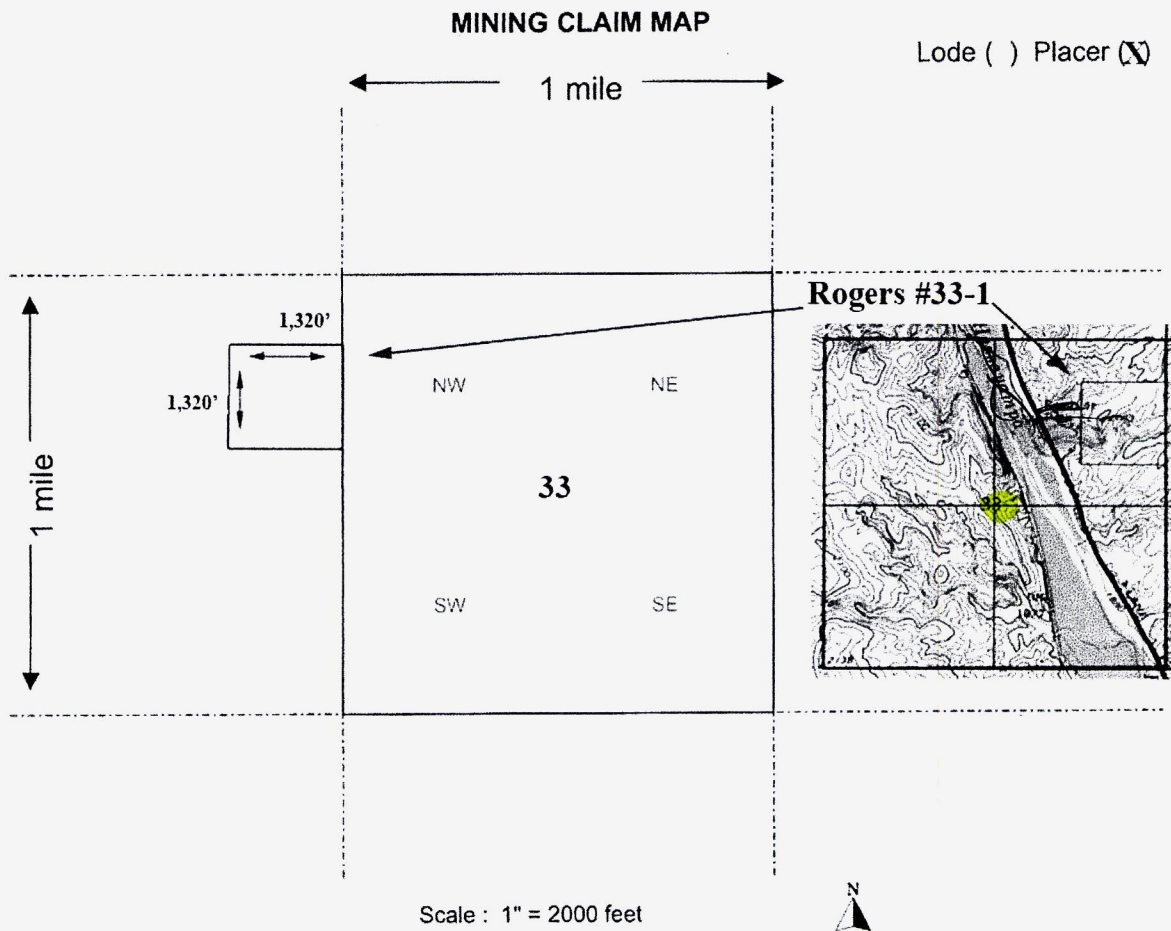

1. The above map depicts the **Rogers #33-1** mining claim, which is located in Section (s) **33**, Township **7** **N**, Range **4** **W**, Gila and Salt River Base and Meridian, **Maricopa** County, Arizona.
2. The type of corner and location monuments used are as follows: **1 1/2" Poly Pipe, 4 feet long/ cap**
3. The bearings and distances in degrees and feet between claim corners are as depicted on the map.

Form MCF100a
Revised July 2005

This form is available from the **Arizona Department of Mines & Mineral Resources** and may be reproduced.

AMC449120

LOCATION NOTICE FOR PLACER MINING CLAIM

0169582-2-6-3
castilloe

NOTICE IS HEREBY GIVEN that the

BLM

The "Rogers #34-1" placer mining claim has been located

Date

by Randy Sealey, whose current mailing address is

Stamp

1127 Victory Ave.,

Billings, Mt. 59105

RECEIVED
MARICOPA COUNTY RECORDER
2018 FEB 21 A 11:31
PHOENIX, ARIZONA

The general course of this claim is East and West and it is situated in Maricopa County, Arizona. This claim is 1,320 feet in length and 660 feet in width. This claim runs from the location monument on which this location notice is posted approximately 1,320' feet in a W direction to the SW corner and 660 feet in a N direction to the NW corner.

Four monuments mark this claim, one at each corner.

The location monument on which this notice is posted is situated within Section 34, Township 7 North, Range 4 West, Gila Salt River Base and Meridian, Arizona and this claim encompasses portions of the following quarter section (s), section (s), Township (s) and Range (s) N1/2 NW1/4 NW1/4 of Section 34, T7N, R4W Gila Salt River Base and Meridian, Arizona. The locality of this claim with reference to some natural object or permanent monument and additional information (If any) concerning its locality are as follows:

This claim is located approximately 1/4 mile W-SW of the 1/4 mile US Survey Marker located between S 27 & S 34 with the wash running E to W through the claim.

DATED AND POSTED on the ground this 18th day of February, 2018.

LOCATOR Randy Sealey

Signature _____

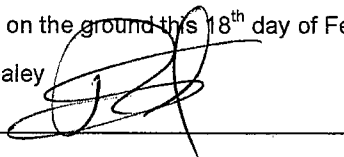

AMC 449121

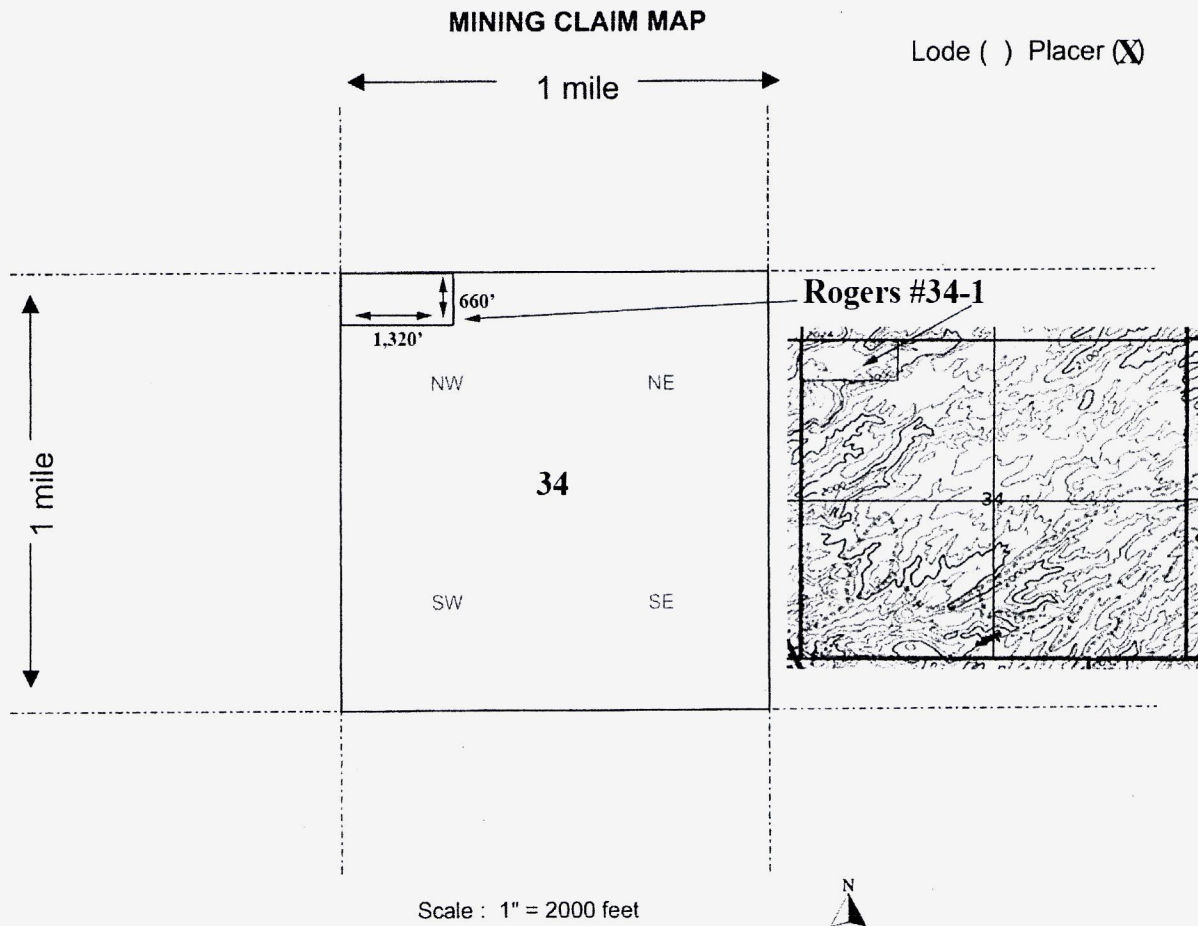

- The above map depicts the **Rogers # 34-1** mining claim, which is located in Section (s) **34**, Township **7** **N**, Range **4** **W**, Gila and Salt River Base and Meridian, **Maricopa** County, Arizona.
- The type of corner and location monuments used are as follows: **1 1/2" Poly Pipe, 4 feet long/ cap**
- The bearings and distances in degrees and feet between claim corners are as depicted on the map.

Form MCF100a
Revised July 2005

This form is available from the **Arizona Department of Mines & Mineral Resources** and may be reproduced.

AMC449121

OFFICIAL RECORDS OF
MARICOPA COUNTY RECORDER
ADRIAN FONTES
2018-0129046 02/21/18 10:32
PAPER RECORDING

0169582-2-6-2
castilloe

LOCATION NOTICE FOR PLACER MINING CLAIM

NOTICE IS HEREBY GIVEN that the

The "Rogers #34-2" placer mining claim has been located

by Randy Sealey, whose current mailing address is

1127 Victory Ave.,

Billings, Mt. 59105

BLM

Date

Stamp

RECEIVED
MARICOPA COUNTY RECORDER
2018 FEB 21 AM 11:31
PHOENIX, ARIZONA

The general course of this claim is East and West and it is situated in Maricopa County, Arizona. This claim is 660 feet in length and 660 feet in width. This claim runs from the location monument on which this location notice is posted approximately 660 feet in a W direction to the SW corner and 660 feet in a N direction to the NW corner.

Four monuments mark this claim, one at each corner.

The location monument on which this notice is posted is situated within Section 34, Township 7 North, Range 4 West, Gila Salt River Base and Meridian, Arizona and this claim encompasses portions of the following quarter section (s), section (s), Township (s) and Range (s) SW1/4 NW1/4 of Section 34, T7N, R4W Gila Salt River Base and Meridian, Arizona. The locality of this claim with reference to some natural object or permanent monument and additional information (if any) concerning its locality are as follows:

This claim is located approximately 2,500' SW of the 1/4 mile US Survey Marker located between S 27 & S 34 with the wash running N to S through the claim.

DATED AND POSTED on the ground this 18th day of February, 2018.

LOCATOR Randy Sealey

Signature _____

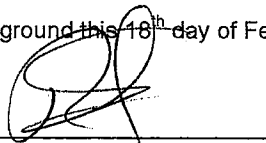

Form MCFIOO
Revised July 2005

AMC449122

MINING CLAIM MAP

Lode () Placer (X)

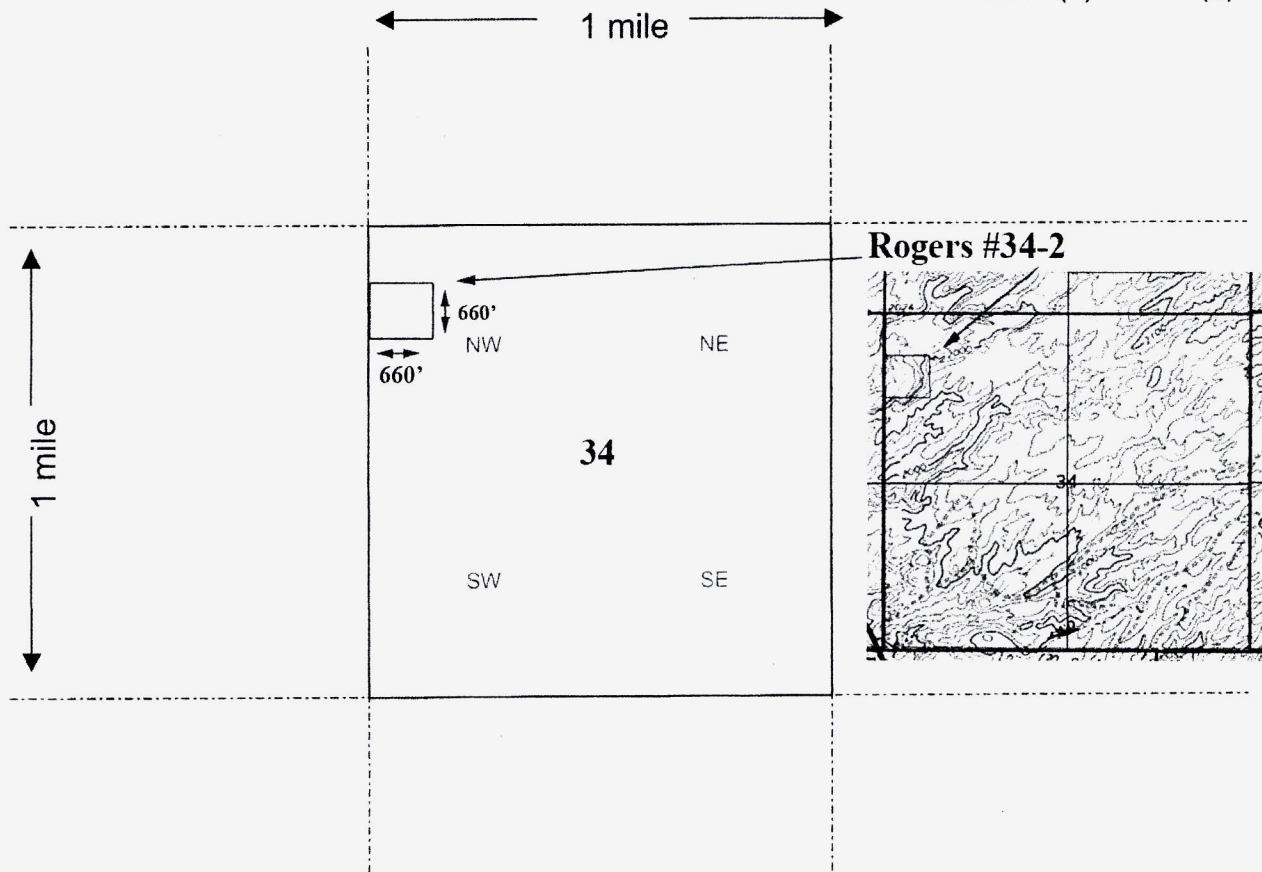

Scale : 1" = 2000 feet



- The above map depicts the Rogers # 34-2 mining claim, which is located in Section (s) 34, Township 7 N, Range 4 W, Gila and Salt River Base and Meridian, Maricopa County, Arizona.
- The type of corner and location monuments used are as follows: 1 1/2" Poly Pipe, 4 feet long/ cap
- The bearings and distances in degrees and feet between claim corners are as depicted on the map.

Form MCF100a
Revised July 2005

This form is available from the Arizona Department of Mines & Mineral Resources and may be reproduced.

AMC49122

MARICOPA/YAVAPAI COUNTY

MARICOPA 013 YAVAPAI 025

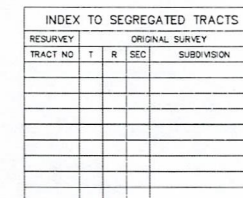

FOR ORDERS AFFECTING DISPOSAL OR USE OF
UNIDENTIFIED LANDS WITHDRAWN FOR CLASSIFICATION,
MINERALS, WATER AND/OR OTHER PUBLIC PURPOSES,
REFER TO INDEX OF MISCELLANEOUS DOCUMENTS.

DIST NO 2

LANDS PATENTED UNDER SMALL TRACT ACT ARE NOW -
SUBJECT TO MINERAL LEASING ACT

A 2889 Recl Stips

AMC 286462 Rec Stips
Sec 33 : M&B

O 195 Opens to ME Sub/ to Stips
Sec 20 : W1/2SW1/4SW1/4

SO 3/12/1948 Opens to ME Subj to Stips
Sec 33 : NE1/4NE1/4SE1/4, Those Portions of
NW1/4NE1/4SE1/4 of Hwy R/W of
5/14/1918

MDS 280 SW
281 SE

Lat 33°53'46"N
Long 112°36'59"W

SCALE in chains

10 5 0 10 20 30 40 50 60

WARNING STATEMENT
This plot is the Bureau's Record of Title, and should be used only as a graphic display of the township survey data. Records herein do not reflect title changes which may have been effected by lateral movements of rivers or other bodies of water. Refer to the cadastral surveys for official survey information.

CURRENT TO	BB	T 7 N R 4 W
2-20-2003	PV	

RUN TIME: 11:44 AM

DEPARTMENT OF INTERIOR
BUREAU OF LAND MANAGEMENT

RUN DATE: 02/22/2018
Page 1 of 1

Input Parameters for Geographic Report with Land

System Id = CR

Admin State = AZ

Geo State =

Casetype Begins With

Case Disp Txt = AUTHORIZED, CANCELLED, EXPIRED, PENDING, REJECTED, VOID, WITHDRAWN

Mer Twp Rng =

Section =

Mtrs = 14 0070N 0040W 026, 14 0070N 0040W 027, 14 0070N 0040W 033, 14 0070N 0040W 034, 14 0070N 0040W 999

Commodity =

Commodity Txt =

Pending Org =

Pend Org Decode =

Total Rows Returned: 13

NO WARRANTY IS MADE BY BLM FOR USE OF THE DATA
FOR PURPOSES NOT INTENDED BY BLM

RUN TIME: 11:44 AM

Adm State: AZ

UNITED STATES DEPARTMENT OF INTERIOR
BUREAU OF LAND MANAGEMENT
GEOGRAPHIC REPORT WITH LAND
Sorted by Serial Number

RUN DATE: 02/22/2018
Page 1 of 3

Serial Number: AZA 004441

Total Case Acres: 1.450

<u>Casetype</u>	<u>Case Disp</u>	14	0070N	0040W	<u>Sect</u>	<u>Sur Typ</u>	<u>Sur Num</u>	<u>Suff</u>	<u>Subdivision</u>	<u>Act Pend</u>
285002	AUTHORIZED				033	ALIQ			NENE;	
					034	ALIQ			W2NWNW,W2SWSE;	

Serial Number: AZA 020865

Total Case Acres: 0.320

<u>Casetype</u>	<u>Case Disp</u>	14	0070N	0040W	<u>Sect</u>	<u>Sur Typ</u>	<u>Sur Num</u>	<u>Suff</u>	<u>Subdivision</u>	<u>Act Pend</u>
281001	AUTHORIZED				027	MNR		1	W2W2SW;	

Serial Number: AZA 031568

Total Case Acres: 1.000

<u>Casetype</u>	<u>Case Disp</u>	14	0070N	0040W	<u>Sect</u>	<u>Sur Typ</u>	<u>Sur Num</u>	<u>Suff</u>	<u>Subdivision</u>	<u>Act Pend</u>
293200	EXPIRED				026	FF			PORTION OF;	
					034	FF			PORTION OF;	

Serial Number: AZA 035151

Total Case Acres: 1.000

<u>Casetype</u>	<u>Case Disp</u>	14	0070N	0040W	<u>Sect</u>	<u>Sur Typ</u>	<u>Sur Num</u>	<u>Suff</u>	<u>Subdivision</u>	<u>Act Pend</u>
293200	PENDING				026	FF			PORTION OF;	

Serial Number: AZA 035961

Total Case Acres: 1.000

<u>Casetype</u>	<u>Case Disp</u>	14	0070N	0040W	<u>Sect</u>	<u>Sur Typ</u>	<u>Sur Num</u>	<u>Suff</u>	<u>Subdivision</u>	<u>Act Pend</u>
380913	EXPIRED				027	ALIQ			W2W2NW,NWSW;	Y

RUN TIME: 11:44 AM

Adm State: AZ

UNITED STATES DEPARTMENT OF INTERIOR
BUREAU OF LAND MANAGEMENT
GEOGRAPHIC REPORT WITH LAND
Sorted by Serial Number

RUN DATE: 02/22/2018
Page 2 of 3

Serial Number: AZA 036509
Total Case Acres: 0.505

<u>Casetype</u>	<u>Case Disp</u>	14	0070N	0040W	<u>Sect</u>	<u>Sur Typ</u>	<u>Sur Num</u>	<u>Suff</u>	<u>Subdivision</u>	<u>Act Pend</u>
288100	AUTHORIZED				033	ALIQ ALIQ			NESE; SENE;	

Serial Number: AZA 036687
Total Case Acres: 1.020

<u>Casetype</u>	<u>Case Disp</u>	14	0070N	0040W	<u>Sect</u>	<u>Sur Typ</u>	<u>Sur Num</u>	<u>Suff</u>	<u>Subdivision</u>	<u>Act Pend</u>
285003	AUTHORIZED				033	ALIQ			NESE,SENE;	Y

Serial Number: AZA 037405
Total Case Acres: 1.000

<u>Casetype</u>	<u>Case Disp</u>	14	0070N	0040W	<u>Sect</u>	<u>Sur Typ</u>	<u>Sur Num</u>	<u>Suff</u>	<u>Subdivision</u>	<u>Act Pend</u>
380913	PENDING				026	FF			SE;	

Serial Number: AZAR 0018373
Total Case Acres: 0.339

<u>Casetype</u>	<u>Case Disp</u>	14	0070N	0040W	<u>Sect</u>	<u>Sur Typ</u>	<u>Sur Num</u>	<u>Suff</u>	<u>Subdivision</u>	<u>Act Pend</u>
286202	AUTHORIZED				033	ALIQ			NENE;	

Serial Number: AZAR 0032173
Total Case Acres: 0.600

<u>Casetype</u>	<u>Case Disp</u>	14	0070N	0040W	<u>Sect</u>	<u>Sur Typ</u>	<u>Sur Num</u>	<u>Suff</u>	<u>Subdivision</u>	<u>Act Pend</u>
282103	AUTHORIZED				033	ALIQ			W2NESE;	

RUN TIME: 11:44 AM

Adm State: AZ

UNITED STATES DEPARTMENT OF INTERIOR
BUREAU OF LAND MANAGEMENT
GEOGRAPHIC REPORT WITH LAND
Sorted by Serial Number

RUN DATE: 02/22/2018
Page 3 of 3

Serial Number: AZPHX 0084146
Total Case Acres: 4.590

<u>Casetype</u>	<u>Case Disp</u>	14	0070N	0040W	<u>Sect</u>	<u>Sur Typ</u>	<u>Sur Num</u>	<u>Suff</u>	<u>Subdivision</u>	<u>Act Pend</u>
✓ 282105	AUTHORIZED				033	ALIQ			NESE;	

Serial Number: AZPHX 0086554
Total Case Acres: 278.790

<u>Casetype</u>	<u>Case Disp</u>	14	0070N	0040W	<u>Sect</u>	<u>Sur Typ</u>	<u>Sur Num</u>	<u>Suff</u>	<u>Subdivision</u>	<u>Act Pend</u>
✓ 284004	AUTHORIZED				033	ALIQ			NENW,W2NE,SE;	

TOWNSHIP 07 NORTH RANGE 04 WEST OF THE GILA & SALT RIVER MERIDIAN, ARIZONA

SECS	SUBDIVISION																Acres	Kind of Entry or Purpose	Serial Number or Order Number	Action Date	Remarks		
	NE 1/4				NW 1/4				SW 1/4				SE 1/4									Lots	Other Description
	NE	NW	SW	SE	NE	NW	SW	SE	NE	NW	SW	SE	NE	NW	SW	SE							
	For orders affecting disposal or use of unidentified lands withdrawn for classification, minerals, water, and/or other public purposes, and Indian treaties, refer to Index to Miscellaneous Documents																						
																	ALL SECS 16 AND 36;		TERRITORIAL RESERVATION	ACT OF CONGRESS	2/24/1863	EXTENDS AND CONTINUES IN FORCE ACTS OF 9/9/1850 AND 7/22/1854;	
20									X						X	X							
29		X																160.00	PATENT / CE	94	11/10/1877		
28						X			X														
29	X			X														160.00	PATENT / CE	96	11/10/1877		
33			X											X	X	X		160.00	PATENT / CE	95	7/15/1878		
28									X			X											
33		X			X													160.00	PATENT / CE	141	5/15/1880		
19	X																						
20						X	X			X								160.00	PATENT / HE	53	11/20/1883		
7																							
18																							
19																							
20																							
28																							
29																							
33																	M&B; SUBDIV UNDEF;		R/W RR	PHX-086554	7/31/1893	PERPETUAL; 7N 5W;	
18																	1-4	160.64	PATENT / HE	677	8/29/1902		
18			X										X	X		X		160.00	PATENT / HE	699	3/17/1903		
7													X	X				80.00	HE	PHX-03398	3/29/1906	CANC 3/1/1910;	
																	ALL SECS 2, 16, 32, 36;		STATE GRANT	ACT OF CONGRESS	6/20/1910	TITLE TO STATE FIXED BY PROC 2/14/1912; SUBJECT TO PRIOR RIGH	
																	ALL SECS 2, 16, 32, 36;		STATE GRANT	ACT OF CONGRESS	6/20/1910	TITLE TO STATE TO FIX ON APPROVAL OF SURVEY; SUBJECT TO PRI	
6			X					X	X				X	X	X	X	2, 3						
7	X	X	X	X									X	X	X	X							
18	X	X		X													9N 3W;	800.21	SO WDL PWR SITE	188 (AR-2)	6/16/1911	SO PART REST 10/31/1933; SO 4/17/1942; EO PART REV 409, 3/12/1926; PART REV PLO 4129, 1/3/1967; PART REV PLO 5303, 11/20/1972;	
7																	3	39.96	PATENT / HE	226331	9/25/1911		
17										X	X							80.00	HE	PHX-015587	9/25/1911	REL 6/17/1912;	
28											X												

SECS	SUBDIVISION																Acres	Kind of Entry or Purpose	Serial Number or Order Number	Action Date	Remarks		
	NE 1/4				NW 1/4				SW 1/4				SE 1/4									Lots	Other Description
	NE	NW	SW	SE	NE	NW	SW	SE	NE	NW	SW	SE	NE	NW	SW	SE							
	For orders affecting disposal or use of unidentified lands withdrawn for classification, minerals, water, and/or other public purposes, and Indian treaties, refer to Index to Miscellaneous Documents																						
33					X	X	X	X				X						M&B; SUBDIV UNDEF;	240.00	DLE	PHX-015802	10/14/1911	CANC 10/27/1913;
1																							
10																							
11																							
12																							
15																							
16																							
17																							
20																		M&B; SUBDIV UNDEF;		R/W PIPELINE	PHX-018984	10/10/1912	APPVD FOR PD ONLY; CANC 11/29/1965;
7																	1, 2		79.83	PATENT / HE	339989	6/7/1913	
23																							
24																							
25																							
26																		M&B; SUBDIV UNDEF;		R/W RESERVOIR AND PIPELINE	PHX-015801	6/17/1913	REV 8/27/1924;
7																	4		39.99	PATENT / HE	386876	2/25/1914	
17																							
18																							
20																							
21																							
28																							
33																							
34																		M&B; SUBDIV UNDEF;		R/W CONDUIT LINE	PHX-011611	10/26/1914	CANC 6/10/1948; 8N 4W;
20												X							40.00	DLE	PHX-026553	2/17/1915	CANC 8/3/1921;
18							X	X				X			X			1S 6E;	160.00	PATENT / INDIAN RESERVATION X	505230	12/30/1915	
17											X	X						80.00	PATENT / HE	508866	1/19/1916		
19				X														40.00	DLE	PHX-026776	4/13/1916	CANC 12/4/1918;	
7												X											
18		X				X												120.00	PATENT / HE	670601	3/19/1		

TOWNSHIP 07 NORTH RANGE 04 WEST OF THE GILA & SALT RIVER MERIDIAN, ARIZONA

SECS	SUBDIVISION																Acres	Kind of Entry or Purpose	Serial Number or Order Number	Action Date	Remarks	
	NE 1/4				NW 1/4				SW 1/4				SE 1/4									
	NE	NW	SW	SE	NE	NW	SW	SE	NE	NW	SW	SE	NE	NW	SW	SE						
	For orders affecting disposal or use of unidentified lands withdrawn for classification, minerals, water, and/or other public purposes, and Indian treaties, refer to Index to Miscellaneous Documents																					
18																						
20																						
21																						
27																						
28																						
34																	M&B; SUBDIV UNDEF;	R/W TELEPHONE AND TELEGRAPH LINE	PHX-040609	6/3/1919	APPVD FOR PD ONLY; PART REL 6/8/1965; EXPIRED 6/2/1969; 3N 1E;	
30																	ALL;					
31																	ALL;					
19		X	X	X	X	X	X	X	X	X	X	X	X	X	X	X						
28											X											
20											X											
29			X		X	X	X	X	X	X			X	X	X	X						
30																	ALL;					
31																	ALL;	PERMIT / OG	PHX-050407	2/28/1922	CANC 12/14/1928;	
22																	ALL;	640.00SRHE	PHX-047825	5/23/1922	CANC 11/18/1927;	
25																	ALL;					
26																	ALL;					
27																	ALL;					
35																	ALL;	2560.00	PERMIT / OG	PHX-053568	10/19/1922	CANC 6/8/1928;
3																	ALL;					
10																	ALL;					
14																	ALL;					
15																	ALL;	PERMIT / OG	PHX-050726	10/24/1922	CANC 6/12/1928;	
4																	ALL;					
5																	ALL;					
8																	ALL;					
9																	ALL;	PERMIT / OG	PHX-050677	10/26/1922	CANC 8/27/1928;	
17	X	X	X	X	X	X	X	X	X				X	X	X	X	X					
20	X	X		X	X								X			X						

TOWNSHIP 07 NORTH RANGE 04 WEST OF THE GILA & SALT RIVER MERIDIAN, ARIZONA

SECs	SUBDIVISION																Acres	Kind of Entry or Purpose	Serial Number or Order Number	Action Date	Remarks			
	NE 1/4				NW 1/4				SW 1/4				SE 1/4									Lots	Other Description	
	NE	NW	SW	SE	NE	NW	SW	SE	NE	NW	SW	SE	NE	NW	SW	SE								
For orders affecting disposal or use of unidentified lands withdrawn for classification, minerals, water, and/or other public purposes, and Indian treaties, refer to Index to Miscellaneous Documents																								
21																		ALL;						
22																		ALL;						
23										X														
28	X	X	X	X	X	X	X	X					X	X	X	X		2560.00	PERMIT / OG	PHX-054293	1/11/1923	CANC 12/12/1928;		
6																	5, 6	79.89	PATENT / HE	903935	4/24/1923			
17	X	X	X	X	X	X	X	X	X				X	X	X	X	X	560.00	PATENT / SRHE	941521	7/17/1924			
20			X				X											80.00	PATENT / HE	947763	11/12/1924			
19		X	X		X		X						X	X		X	1							
29			X		X	X	X	X	X				X	X	X	X								
30	X																							
33					X	X		X	X		X							960.39	OWDL PWR PROJECT	AR-306	11/13/1924	O PART VACATION 4/27/1971;		
18		X																	EO REV PWR SITE RESERVE 188 (AR-2), SO 6/16/1911	409	3/12/1926			
																			ALL SECS 2, 16, 32, 36;		STATE GRANT	ACT OF CONGRESS	1/25/1927	EXTENDS ACT OF 6/20/1910 TO MINERAL LANDS; SUBJECT TO PRIOR RIGHTS;
7			X				X	X						X				160.00	HE	PHX-067063	11/30/1929	REL 3/14/1931;		
28													X	X	X	X		160.00	HE	PHX-067164	12/12/1929	REL 4/4/1932;		
28			X		X	X		X										160.00	HE	PHX-066650	3/5/1930	REL 4/3/1930;		
20	X	X		X	X								X											
21					X	X	X	X	X	X	X	X						520.00	SRHE	PHX-066651	2/5/1931	CANC 3/5/1932;		
20																X		40.00	HE	PHX-067802	2/5/1931	REL 12/27/1932;		
33								X										40.00	HE	PHX-071598	4/5/1932	REL 9/7/1932;		
20	X	X		X	X								X			X								
21					X	X			X	X								400.00	HE	PHX-071609	4/6/1932	PART REL; REL 8/30/1935;		
6																	7	39.90	HE	PHX-071617	4/7/1932	REL 7/13/1933;		
33													X					40.00	HE	PHX-072340	8/20/1932	CANC 11/17/1938;		
20																X		40.00	ASRHE	PHX-072982	1/18/1933	CANC 2/19/1934;		
34									X	X	X							120.00	PATENT / HE	1064608	6/6/1933			
33				X														40.00	HE	PHX-073680	9/5/1933	CANC 11/14/1939;		
7	X	X	X	X	X									X	X	X	X							

TOWNSHIP 07 NORTH RANGE 04 WEST OF THE GILA & SALT RIVER MERIDIAN, ARIZONA

SECS	SUBDIVISION																Acres	Kind of Entry or Purpose	Serial Number or Order Number	Action Date	Remarks		
	NE 1/4				NW 1/4				SW 1/4				SE 1/4									Lots	Other Description
	NE	NW	SW	SE	NE	NW	SW	SE	NE	NW	SW	SE	NE	NW	SW	SE							
For orders affecting disposal or use of unidentified lands withdrawn for classification, minerals, water, and/or other public purposes, and Indian treaties, refer to Index to Miscellaneous Documents																							
18	X			X															SO REST WDL PWR SITE 188 (AR-2), SO 6/16/1911		10/31/1933	OPEN TO ENTRY;	
20					X													40.00	HE	PHX-073763	11/6/1933	REL 5/14/1934;	
18	X																	40.00	HE	PHX-073682	12/5/1933	REL 7/28/1934;	
6																	7	39.90	HE	PHX-074650	4/9/1934	CANC 2/15/1940;	
19				X														40.00	HE	PHX-075293	8/7/1934	REL 11/12/1934;	
20												X						40.00	HE	PHX-075386	9/14/1934	CANC 5/9/1940;	
20					X													40.00	HE	PHX-075405	9/25/1934	REL 2/12/1935;	
33								X										40.00	HE	PHX-075529	10/15/1934	CANC 6/6/1940;	
18				X														40.00	PATENT / HE	1078942	10/8/1935		
7					X			X	X									120.00	PATENT / HE	1084600	6/30/1936		
28			X		X	X		X										160.00	PATENT / HE	1087824	12/30/1936		
19				X														40.00	PATENT / HE	1103990	7/24/1939		
7															X			40.00	PATENT / HE	1110357	2/6/1941		
7																X							
18	X																	80.00	PATENT / HE	1112276	10/20/1941		
28													X	X		X	1	146.97	PATENT / HE	1113227	3/3/1942		
6																X			SO REST WDL PWR SITE 188 (AR-2), SO 6/16/1911		4/17/1942	OPEN TO ENTRY;	
2																		640.00	SX WAIVER	PHX-077472	6/1/1942	8S 16E;	
6																X							
7		X	X											X				160.00	PATENT / PS	1114176	6/16/1942		
19		X	X																				
20					X						X	X	X			X							
28											X												
29			X																				
33	X			X									X										
34								X										5N 4W;	SO WDL HASSAYAMPA PROJECT		4/7/1944	SO PART REV 10/29/1953; PART REV PLO 4835, 5/20/1970; (A-12828); PART REV PLO 6353, 3/3/1983;	
24					X							X						8N 3W;	80.00	PATENT / PX	1123244	2/19/1948	

TOWNSHIP 07 NORTH RANGE 04 WEST OF THE GILA & SALT RIVER MERIDIAN, ARIZONA

SECS	SUBDIVISION																Acres	Kind of Entry or Purpose	Serial Number or Order Number	Action Date	Remarks		
	NE 1/4				NW 1/4				SW 1/4				SE 1/4									Lots	Other Description
	NE	NW	SW	SE	NE	NW	SW	SE	NE	NW	SW	SE	NE	NW	SW	SE							
	For orders affecting disposal or use of unidentified lands withdrawn for classification, minerals, water, and/or other public purposes, and Indian treaties, refer to Index to Miscellaneous Documents																						
33																		NENESE, PART NWNESE LYING EAST OF HWY R/W;		SO OPENING TO ME		3/12/1948	SUBJECT TO STIPULATIONS; EFF AT 10:00 AM ON 5/14/1948;
20												X				X				R/W HIGHWAY	PHX-084145	6/8/1948	PERPETUAL; PROOF OF CONSTRUCTION 6/18/1964;
33												X								R/W HIGHWAY	PHX-084146	6/8/1948	PERPETUAL; PROOF OF CONSTRUCTION 6/18/1964;
20												X				X		80.00	SO REV HASSAYAMPA PROJECT, SO 4/7/1944			10/29/1953	
20						X						X				X							
21										X								M&B;		R/W GAS PIPELINE	AR-07526	7/13/1955	PERPETUAL;
20												X				X		80.00	PATENT / PX	1153913	8/29/1955		
6																		5.00	N2SENE;	1154533	9/27/1955	NOT OPEN TO MINING; SUBJECT TO MINERAL LEASING;	
28																		12.926	MS 4299;	1157945	3/12/1956		
28																			SESWSENE, SWSENE;	FUP	29	7/18/1957	EXPIRED 8/1/1962;
33	X																		M&B;	R/W TELEPHONE AND TELEGRAPH LINE	AR-018373	7/14/1958	TO TERM 7/13/2008; PROOF OF CONSTRUCTION ACCEPTED 4/19/1963;
20																			W2SWSW;	O OPENING TO ENTRY	195	11/21/1958	SUBJECT TO STIPULATIONS;
20																		5.00	N2SWNENW;	1205951	3/7/1960	NOT OPEN TO MINING; SUBJECT TO MINERAL LEASING;	
20																		5.00	E2NENENW;	1206091	3/8/1960	NOT OPEN TO MINING; SUBJECT TO MINERAL LEASING;	
20																		5.00	S2SWNENW;	1206092	3/8/1960	NOT OPEN TO MINING; SUBJECT TO MINERAL LEASING;	
20																		5.00	E2SENEENW;	1206093	3/8/1960	NOT OPEN TO MINING; SUBJECT TO MINERAL LEASING;	
20																		5.00	W2NENENW;	1206094	3/8/1960	NOT OPEN TO MINING; SUBJECT TO MINERAL LEASING;	
20																		5.00	W2SENEENW;	1206095	3/8/1960	NOT OPEN TO MINING; SUBJECT TO MINERAL LEASING;	
20																		5.00	W2NWNENW;	1206096	3/8/1960	NOT OPEN TO MINING; SUBJECT TO MINERAL LEASING;	
20																		5.00	E2NWNENW;	1206097	3/8/1960	NOT OPEN TO MINING; SUBJECT TO MINERAL LEASING;	
6				X														115.19	SS UNIVERSITY PURPOSES	18	11/8/1960		
5																		40.24	4	PATENT / ME	1221553	7/28/1961	
6												X						40.00		MINING CLAIM LOCATION - PL 359	AR-031264	1/22/1962	MINING CLAIM DECLARED NULL AND VOID; CANC 3/21/1966;
6													X					40.00		MINING CLAIM LOCATION - PL 359	AR-031265	1/22/1962	MINING CLAIM DECLARED NULL AND VOID; CANC 3/21/1966;
6			X															40.00		MINING CLAIM LOCATION - PL 359	AR-031266	1/22/1962	MINING CLAIM DECLARED NULL AND VOID; CANC 3/21/1966;
6								X										40.00		MINING CLAIM LOCATION - PL 359	AR-031267	1/22/1962	MINING CLAIM DECLARED NULL AND VOID; CANC 3/21/1966;
6									X									40.00		MINING CLAIM LOCATION - PL 359	AR-031268	1/22/1962	MINING CLAIM DECLARED NULL AND VOID; CANC 3/21/1966;
33																			W2NESE;	R/W HIGHWAY	AR-032173	5/6/1963	PERPETUAL; 6N 4W;

TOWNSHIP 07 NORTH RANGE 04 WEST OF THE GILA & SALT RIVER MERIDIAN, ARIZONA

SECS	SUBDIVISION																Acres	Kind of Entry or Purpose	Serial Number or Order Number	Action Date	Remarks			
	NE 1/4				NW 1/4				SW 1/4				SE 1/4									Lots	Other Description	
	NE	NW	SW	SE	NE	NW	SW	SE	NE	NW	SW	SE	NE	NW	SW	SE								
For orders affecting disposal or use of unidentified lands withdrawn for classification, minerals, water, and/or other public purposes, and Indian treaties, refer to Index to Miscellaneous Documents																								
33													X					SWSENE;		R/W TRANSMISSION LINE	AR-033173	3/3/1965	EFF 2/12/1964; TO TERM 3/2/2015, CASE CLOSED 9/21/2016;	
6			X					X	X			X	X	X				7		279.90	O CL / R&PP	AR-032282	1/4/1966	PATENT 02-67-0004, 7/29/1966;
6																		S2 OF 3			AR-035809	4/13/1966	EXPIRED 4/12/1967;	
6			X					X	X			X	X	X				7		279.90	PATENT / R&PP	02-67-0004	7/29/1966	NOT OPEN TO MINERAL ENTRY; SUBJ TO MINERAL LEASING ACT; (AR-032282);
6			X					X	X				X	X		X		2, 3		320.21	PLO PART REV PWR SITE RESERVE 188, EO 6/16/1911	4129	1/3/1967	
6																		S2 OF 3			A-761	3/10/1967	EXPIRED 4/23/1968;	
ENTIRE TOWNSHIP																		1N 4W;			O PROPOSED CL FOR MULTIPLE USE MANAGEMENT	A-1100	7/21/1967	SEGREGATES THE PUBLIC LANDS FROM APPROPRIATION UNDER AGRICULTURAL LAND LAWS; PS, SX; PUB IN FR 7/27/1967; O CL 10/17/1967; PUB IN FR 10/23/1967; CL TERM 10/7/1981;
6																X		2, 3	10N 4W;	120.21	447	11/25/1968		
34	X	X	X	X	X			X	X	X			X	X				SENWNW, NESWSE;	420.00	O CL / EXCHANGE	A-3910	5/5/1970		
34										X										40.00	PLO PART REV WDL HASSAYAMPA PROJECT, SO 4/7/1944	4835	5/20/1970	
34	X	X	X	X	X			X	X	X			X	X				SENWNW, NESWSE;	420.00	APLN / PX	A-3910	6/17/1970		
34	X	X	X	X	X			X	X	X			X	X				SENWNW, NESWSE;	420.00	PATENT / PX	02-71-0039	12/11/1970	(A-3910);	
19		X	X		X			X					X	X		X		1						
29			X		X	X	X	X	X				X	X	X	X								
30	X																							
33						X	X		X	X		X									O VACATION FPC PWR PROJECT 306, O 12/15/1924	A-6225	4/27/1971	
19		X	X		X			X					X	X		X		1						
29			X		X	X	X	X	X				X	X	X	X								
30	X																							
33						X	X		X	X		X						9N 3W;			O OPENING TO ENTRY	A-6225	9/20/1971	
21												X												
33	X																							
34																		W2NWNW, W2SWSE;			R/W TELEPHONE AND TELEGRAPH LINE	A-4441	12/30/1971	TO TERM 12/29/2021; OTHER TP: 6N 4W;
6																X								
7	X	X	X	X	X								X	X	X	X		E2NE, NESE;						OPEN TO ENTRY AT 10:00 AM ON 12/26/1972;

TOWNSHIP 07 NORTH RANGE 04 WEST OF THE GILA & SALT RIVER MERIDIAN, ARIZONA

SECS	SUBDIVISION																Acres	Kind of Entry or Purpose	Serial Number or Order Number	Action Date	Remarks		
	NE 1/4				NW 1/4				SW 1/4				SE 1/4									Lots	Other Description
	NE	NW	SW	SE	NE	NW	SW	SE	NE	NW	SW	SE	NE	NW	SW	SE							
For orders affecting disposal or use of unidentified lands withdrawn for classification, minerals, water, and/or other public purposes, and Indian treaties, refer to Index to Miscellaneous Documents																							
18	X			X														3N 3W;		PLO REV AND REST PWR SITE 188, EO 6/16/1911	5303	11/20/1972	
5										X	X			X	X			S2N2S2, N2NESW, N2NESE, SWSENW, E2SWNW;	330.00	CL / IL	A-6845	5/14/1975	7N 5W;
5																		W2SWNW, N2NWSW;	40.00	CL / R&PP	A-7871	1/23/1976	SEGREGATED FROM ALL FORMS OF APPROPRIATION, INCLUDING LOCATION UNDER THE MINING LAWS, BUT NOT THE MINERAL LEASING LAWS;
5																		W2SWNW, N2NWSW;	40.00	LEASE / R&PP	A-7871	5/24/1977	TO TERM 5/23/1997; RENEWED; TO TERM 5/23/2007; RENEWED; TO TE 5/23/2027;
17	X	X	X	X	X	X	X	X	X	X			X	X	X	X	X						
20														X			X			APLN / TEMP WDL FROM MINERAL ENTRY	A-10898	4/10/1979	SEGREGATED FROM ALL FORMS OF APPROPRIATION UNDER THE GENERAL MINING LAWS, BUT NOT THE MINERAL LEASING LAWS; PUB IN FR 4/10/1979; OTHER TPS: 7N 5W, 8N 5W; WDL FROM ME PLO 6502, 1/23/1984;
8																		ALL;					
21																		ALL;					
27																		ALL;	1920.00	LEASE / OG	A-14542	3/24/1981	EFF 4/1/1981; TERM 4/1/1987; OG SIM DEC 1987;
9																		ALL;					
15																		ALL;					
22																		ALL;					
26						X	X		X	X	X	X	X	X	X	X							
35																		ALL;	2960.00	LEASE / OG	A-14743	3/24/1981	EFF 4/1/1981; TERM 4/1/1985; OG SIM AUG 1985;
1			X	X			X	X	X	X	X	X	X	X	X	X	1-4						
2			X				X	X	X	X	X	X		X	X		1-7						
11		X	X		X	X	X	X	X	X	X	X		X	X		1-4						
12																		ALL;					
13																		ALL;					
14	X				X	X	X	X	X	X	X	X	X			X	1-4						
23																		ALL;					
24																		ALL;					
25																		ALL;	5709.97	LEASE / OG	A-15028	5/27/1981	EFF 6/1/1981; TERM 6/1/1984; OG SIM DEC 1985;
3			X				X	X	X	X	X	X				X	1-7						
4			X	X			X	X	X	X	X	X	X	X	X	X	1-4						
5			X	X													1-3	N2SENW, SESENW, N2NWSE;					

TOWNSHIP 07 NORTH RANGE 04 WEST OF THE GILA & SALT RIVER MERIDIAN, ARIZONA

SECS	SUBDIVISION																Acres	Kind of Entry or Purpose	Serial Number or Order Number	Action Date	Remarks		
	NE 1/4				NW 1/4				SW 1/4				SE 1/4									Lots	Other Description
	NE	NW	SW	SE	NE	NW	SW	SE	NE	NW	SW	SE	NE	NW	SW	SE							
For orders affecting disposal or use of unidentified lands withdrawn for classification, minerals, water, and/or other public purposes, and Indian treaties, refer to Index to Miscellaneous Documents																							
10					X	X	X	X	X	X	X						1-8						
17	X	X	X	X	X	X	X	X	X		X	X	X	X	X								
19		X	X		X			X	X			X	X	X	X	X	1-4						
29					X	X	X	X	X	X	X	X	X	X	X	X							
30	X	X	X	X	X			X	X				X	X	X	X	1-4						
31	X	X	X	X	X			X	X				X	X	X	X	1-4						
33	X			X		X	X	X	X	X	X												
34																X		N2NWNW, SWNWNW, S2SWSE, NWSWSE;	5536.47	LEASE / OG	A-15015	5/30/1981	EFF 6/1/1981; TERM 6/4/1984; OG SIM PART DEC 1984;
26	X	X	X	X	X			X										240.00	LEASE / OG	A-15433	5/30/1981	EFF 6/1/1981; TERM 6/1/1983; OG SIM SEP 1983;	
3							X			X							3, 4	N2N2SWSW;					
4																							
5			X	X				X	X		X	X	X	X	X	X	1-3	E2SWNW, S2NWSW;					
7	X			X									X										
8																							
9									X	X													
20		X		X																			
21									X	X								W2NESW, NWSESW;	2443.99	APLN / IL	A-17000-C	8/27/1981	SEGREGATED FROM THE PUBLIC LAND LAWS, INCLUDING THE MINING LAWS, BUT NOT THE MINERAL LEASING LAWS; O OPENING TO ENTRY 8/27/1983; PART WDN 7/22/1983;
33													X					S2SENE;	60.00	APLN / IL	A-17000-D	8/27/1981	SEGREGATED FROM THE PUBLIC LAND LAWS, INCLUDING THE MINING LAWS, BUT NOT THE MINERAL LEASING LAWS; WDN FROM IL APLN 2/24/1982; O OPENING TO ENTRY 5/2/1983;
3							X			X							3, 4	N2N2SWSW;					
4			X	X			X	X	X	X	X	X	X	X	X	X	1-4						
5				X					X		X	X	X	X	X	X	1	S2NWSW;					
7	X			X										X									
8																							
9										X	X												
21										X	X							W2NESW, NWSESW;	2143.33	IL	553	9/14/1981	[A-17000-C]; 6N 4W;
20		X		X														3S 1E;	80.00	IL	571	9/30/1982	[A-17000-C];

TOWNSHIP 07 NORTH RANGE 04 WEST OF THE GILA & SALT RIVER MERIDIAN, ARIZONA

SECS	SUBDIVISION																Acres	Kind of Entry or Purpose	Serial Number or Order Number	Action Date	Remarks		
	NE 1/4				NW 1/4				SW 1/4				SE 1/4									Lots	Other Description
	NE	NW	SW	SE	NE	NW	SW	SE	NE	NW	SW	SE	NE	NW	SW	SE							
	For orders affecting disposal or use of unidentified lands withdrawn for classification, minerals, water, and/or other public purposes, and Indian treaties, refer to Index to Miscellaneous Documents																						
17																	M&B NWNWNW, N2SWNWNW;	12.50	PATENT / MINERAL INTERESTS	02-83-0014	12/17/1982	(A-17286); OG RESERVED TO US;	
17																	E2SESWSE;	5.00	PATENT / MINERAL INTERESTS	02-83-0019	1/31/1983	(A-17293);	
19		X	X																				
20					X						X	X											
28											X												
29			X																				
33	X			X									X				5N 3W;	400.00	PLO PART REV WDL HASSAYAMPA, EO 4/7/1944	6353	3/3/1983	(A-12828); PD RESTORED TO ENTRY 4/13/1983;	
33													X				S2SENE;	60.00	O OPENING TO ENTRY	A-17000-D	5/2/1983		
5			X					X									2, 3	E2SWNW;		O OPENING TO ENTRY	A-17000-C	8/27/1983	
21																	S2SESW;	20.00	O CL / PX	A-18935	11/10/1983	SEGREGATED FROM THE PUBLIC LAND LAWS, INCLUDING THE MINING LAWS, BUT NOT THE MINERAL LEASING LAWS; SEG TO TERM 11/9/1985;	
17	X	X	X	X	X			X	X			X	X	X		X	E2W2NW, S2SWNWNW, W2SWNW, W2SWSE, NESWSE, W2SESWSE, PART N2SWNWNW;						
20													X			X				PLO WDL FROM ME	6502	1/23/1984	(A-10898); SURFACE MINING CONTROL AND RECL ACT OF 1977; DESIGNATED UNSUITABLE FOR NON-COAL MINING; OPEN TO THE MINERAL LEASING LAWS, TO TERM 1/22/1989; OTHER TPS: 7N 5W, 8N 5W;
20																	PART E2SE;	6.80	PATENT / CMI	02-84-0058	7/10/1984	OG RESERVED TO US, (A-19250);	
5						X	X										3			R/W ROAD	A-19331	8/3/1984	PERPETUAL; LD TP: 8N 3W;
20																	PART E2SE;	16.00	PATENT / CMI	02-84-0065	8/13/1984	OG RESERVED TO US, (A-19228);	
17																	S2NENESE, N2SENESE;	10.00	PATENT / CMI	02-85-0009	11/21/1984	OG RESERVED TO US, (A-19353);	
17																	M&B NE;	10.27	PATENT / CMI	02-85-0016	12/10/1984	OG RESERVED TO US, (A-19337);	
17																	PART E2NE;	4.97	PATENT / CMI	02-85-0018	12/14/1984	OG RESERVED TO US, (A-19384);	
20																	PART E2SE;	35.00	PATENT / CMI	02-85-0035	1/24/1985	(A-19997);	
17																	PART NESWSE;	5.45	PATENT / CMI	02-85-0063	8/23/1985	(A-20888);	
17																	W2SWSESW;	5.00	PATENT / CMI	02-86-0007	11/6/1985	(A-20232);	
27																	W2W2SW;	0.32	R/W ROAD	A-20865	11/13/1985	TO TERM 11/12/2015;	
17																	NESWSWSE, NWSENWSE;	0.50	PATENT	02-89-0023	8/11/1989	(A-22530);	
17																	PART SENE;		NORA / CMI	AZA-22628	8/8/1991	SEGREGATES THE MINERAL INTERESTS FROM APPROPRIATION UNDER THE MINING LAWS AND MINERAL LEASING LAWS; SEG TO TERM 8/7/1993;	

TOWNSHIP 07 NORTH RANGE 04 WEST OF THE GILA & SALT RIVER MERIDIAN, ARIZONA

SECS	SUBDIVISION																Acres	Kind of Entry or Purpose	Serial Number or Order Number	Action Date	Remarks				
	NE 1/4				NW 1/4				SW 1/4				SE 1/4									Lots	Other Description		
	NE	NW	SW	SE	NE	NW	SW	SE	NE	NW	SW	SE	NE	NW	SW	SE									
	For orders affecting disposal or use of unidentified lands withdrawn for classification, minerals, water, and/or other public purposes, and Indian treaties, refer to Index to Miscellaneous Documents																								
17																		ALL;		APLN / CMI	AZA-22628	7/29/1993	SEGREGATES THE MINERAL INTERESTS FROM APPROPRIATION UNDER THE MINING LAWS AND MINERAL LEASING LAWS; SEG TO TERM 7/28/1995; LD TP: 5N 2E;		
20													X					LD TP: 6N 4W;		R/W BURIED FIBER OPTIC CABLE	AZA-27844	1/20/1994	TO TERM 1/19/2024; AMENDED 4/15/1999;		
17																		M&B;	4.60	PATENT / CMI	02-95-0003	11/4/1994	{A-22628};		
5			X					X										2, 3		E2SWNW;		NORA / R&PP	AZA-29639	6/3/1996	SEGREGATES THE LANDS FROM ALL FORMS OF APPROPRIATION UNDER THE PUBLIC LAND LAWS, INCLUDING THE GENERAL MINING LAWS, E. FOR LEASE OR CONVEYANCE UNDER THE R&PP ACT; CL TERM, LAND OPENED AND CASE CLOSED 9/3/1998;
5							X	X										3			R/W ROAD	AZA-32123	8/14/2002	PERPETUAL; OTHER TPS: 8N 3W, 9N 3W;	
33				X									X								R/W POWER TRANSMISSION LINE	AZA-36687	9/20/2016	TO TERM 12/31/2044;	

DEPARTMENT OF THE INTERIOR
BUREAU OF LAND MANAGEMENT
MINING CLAIMS

Run Date/Time: 02/22/2018 12:33 PM

(LIVE) Serial Register Page

Page 1 of 1

01 10-21-1976;090STAT0090;43USC1744

Case Type 384201: PLACER CLAIM

Claim Name: ROGERS 34-1

Commodity :

Case Disposition: ACTIVE

Required Maintenance Fee: \$155.00

Total Acres

20.000

Serial Number

AMC449121

Lead File Number

AMC449117

Name & Address

SEALEY RANDY L

1127 VICTORY AVE

BILLINGS, MT 59105-1856

Int Rel

CLAIMANT

Mer Twp Rng Sec Quadrant

14 0070N 0040W 034

NW

District/Field Office

HASSAYAMPA FO

County

MARICOPA

Act Date

Code Action

Action Remarks

Receipt Number

02/18/2018 403 LOCATION DATE

02/21/2018 395 RECORDATION NOTICE RECD

1

4092763

02/18/2018 484 LOCATION YEAR / MAINTENANCE 2018;\$155

4092763

2/21/18 corrected 3/26/18

02/21/2018 404 COUNTY RECORDATION

2018-0129047;

02/21/2018 501 ACCT ADV IN LEAD FILE

AMC449117-AMC449112;

122 corrected
3-23-18

Line Nr Remarks

**DEPARTMENT OF THE INTERIOR
BUREAU OF LAND MANAGEMENT
MINING CLAIMS**

Run Date/Time: 02/22/2018 12:34 PM

(LIVE) Serial Register Page

Page 1 of 1

01 10-21-1976;090STAT0090;43USC1744

Case Type 384201: PLACER CLAIM

Claim Name: ROGERS 34-2

Commodity :

Case Disposition: ACTIVE

Required Maintenance Fee: \$155.00

Total Acres

10.000

Serial Number

AMC449122

Lead File Number

AMC449117

Name & Address

Int Rel

SEALEY RANDY L

1127 VICTORY AVE

BILLINGS, MT 59105-1856

CLAIMANT

Mer Twp Rng Sec Quadrant

District/Field Office

County

14 0070N 0040W 034

NW

HASSAYAMPA FO

MARICOPA

Act Date

Code Action

Action Remarks

Receipt Number

02/18/2018

403

LOCATION DATE

02/21/2018

395

RECORDATION NOTICE RECD

1

4092763

02/18/2018

484

LOCATION YEAR / MAINTENANCE 2018;\$155

4092763

2/21/18

Corrected 3/26/18

02/21/2018

404

COUNTY RECORDATION

2018-0129046;

02/21/2018

501

ACCT ADV IN LEAD FILE

AMC449117-AMC449112;

449122

corrected 3-28-18

Line Nr Remarks